



3003 77TH AVE SE., MERCER ISLAND, WA 98049





© 2024 Google



1541 S. 92nd Place, #B, Seattle, WA 98108
P: 206-282-0700
www.nationalsigncorp.com

This is an original unpublished drawing, created by National Sign Corporation. It is submitted for your personal use in connection with a project being planned for you by National Sign Corporation. It is not to be shown to anyone outside your organization, or to be used, reproduced, copied or exhibited in any fashion. Any usage beyond that granted to buyer herein shall require the separate payment of a design and engineering fee to National Sign Corporation.

JOB INFORMATION:

Riot Games
3003 77TH AVE SE
MERCER ISLAND, WA 98049

REPRESENTATIVE:

Tom Hubbard

DESIGNER:

Mark Mahan

DATE:

06/10/24

DESIGN NUMBER:

24-00386 V9.1 FP

SCALE:

As Noted

24-01764-05.1

FINAL PRINT

CLIENT INFORMATION:

Riot Games
3003 77TH AVE SE
MERCER ISLAND, WA 98049

REPRESENTATIVE:

Tom Hubbard

DESIGNER:

Mark Mahan

DATE:

06/10/24

REVISION:

1	
2	
3	
4	
5	
6	
7	
8	
9	

REVIEWED BY:

F	
C	
S	
P	

This is an original unpublished drawing, created by National Sign Corporation. It is not to be shown to anyone outside your organization, or to be used, reproduced, copied or exhibited in any fashion. Any usage beyond that granted to buyer herein shall require the separate payment of a design and engineering fee to National Sign Corporation.

SIGN(S) TO BE MANUFACTURED TO U.L. SPECIFICATIONS AND WILL BEAR THE U.L. LABEL(S). INSTALL IN ACCORDANCE WITH NATIONAL ELECTRICAL CODES.

SCALE: As Noted

DESIGN NUMBER:

24-00386 V9.1 FP

JOB NUMBER:

24-01764-OS.1

FINAL PRINT

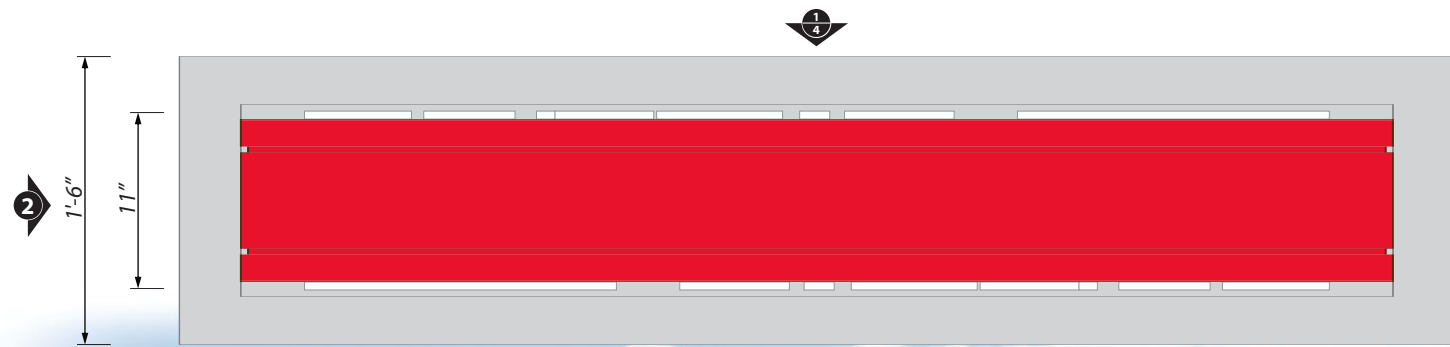

3 Plan View

Scale: 1"=1'-0"

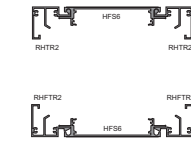

4 Extrusion Section

Scale: 1"=1'-0"

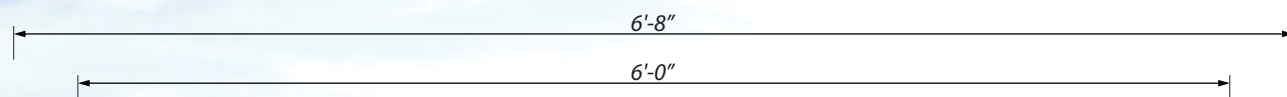

Sign 1:

Manufacture & Install:
(1) Exterior double faced non-illuminated aluminum with routed and pushed thru acrylic monument sign.

- A** Sign cabinet to be extruded aluminum HFS-6 body, with RHTR-2, RHFTR-2 Retainers painted Red to match PMS#185c (satin finish).
- B** Sign face to be .090" aluminum painted Red to match PMS#185c (satin finish).
- C** Logo & "RIOT GAMES" lettering to be routed out of aluminum face and 3/4" thick pushed thru acrylic- Clear, painted White (satin finish). Register Mark to be first surface applied opaque 3M Scotchcal vinyl- White #220-10.
- D** Reveal to be aluminum framework over skinned with .090" aluminum painted Grey to match PMS#2330 (satin finish).
- E** Pipe to be 3" (3.5" o.d.) steel by NSC.
- F** Footing to be concrete by others.



1 Front View- Facing 77th Ave.

Scale: 1"=1'-0"

Square Footage: 13.0 sq. ft.

Soil to cover base concrete.

Soil to cover base concrete.

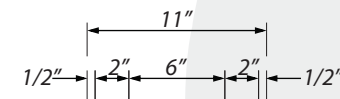

2 Side View

Scale: 1"=1'-0"

CLIENT INFORMATION:

Riot Games
3003 77TH AVE SE
MERCER ISLAND, WA 98049

REPRESENTATIVE:

Tom Hubbard

DESIGNER:

Mark Mahan

DATE:

06/10/24

REVISION:

1	
2	
3	
4	
5	
6	
7	
8	
9	

REVIEWED BY:

F	
C	
S	
P	

This is an original unpublished drawing, created by National Sign Corporation. It is not to be shown to anyone outside your organization, or to be used, reproduced, copied or exhibited in any fashion. Any usage beyond that granted to buyer herein shall require the separate payment of a design and engineering fee to National Sign Corporation.

 SIGN(S) TO BE MANUFACTURED TO U.L. SPECIFICATIONS AND WILL BEAR THE U.L. LABEL(S). INSTALL IN ACCORDANCE WITH NATIONAL ELECTRICAL CODES.

SCALE: As Noted

DESIGN NUMBER:

24-00386 V9.1 FP

JOB NUMBER:

24-01764-OS.2

FINAL PRINT

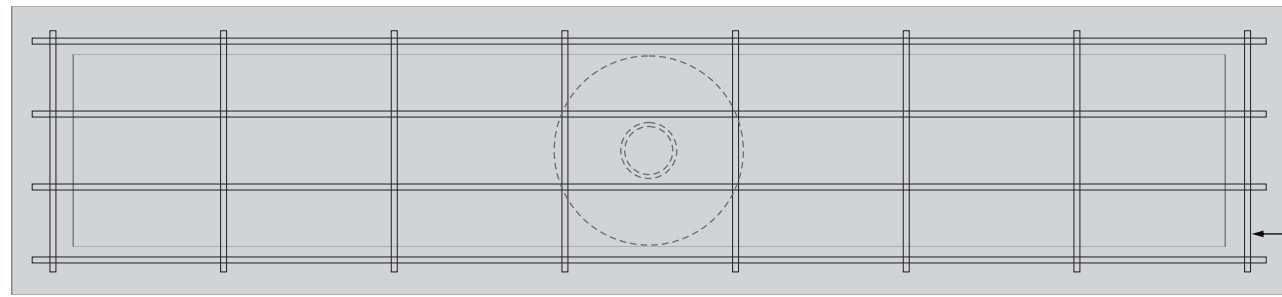

Rebar base
(8) #4 short way
(4) #4 long way

3 Plan View
Scale: 1"=1'-0"

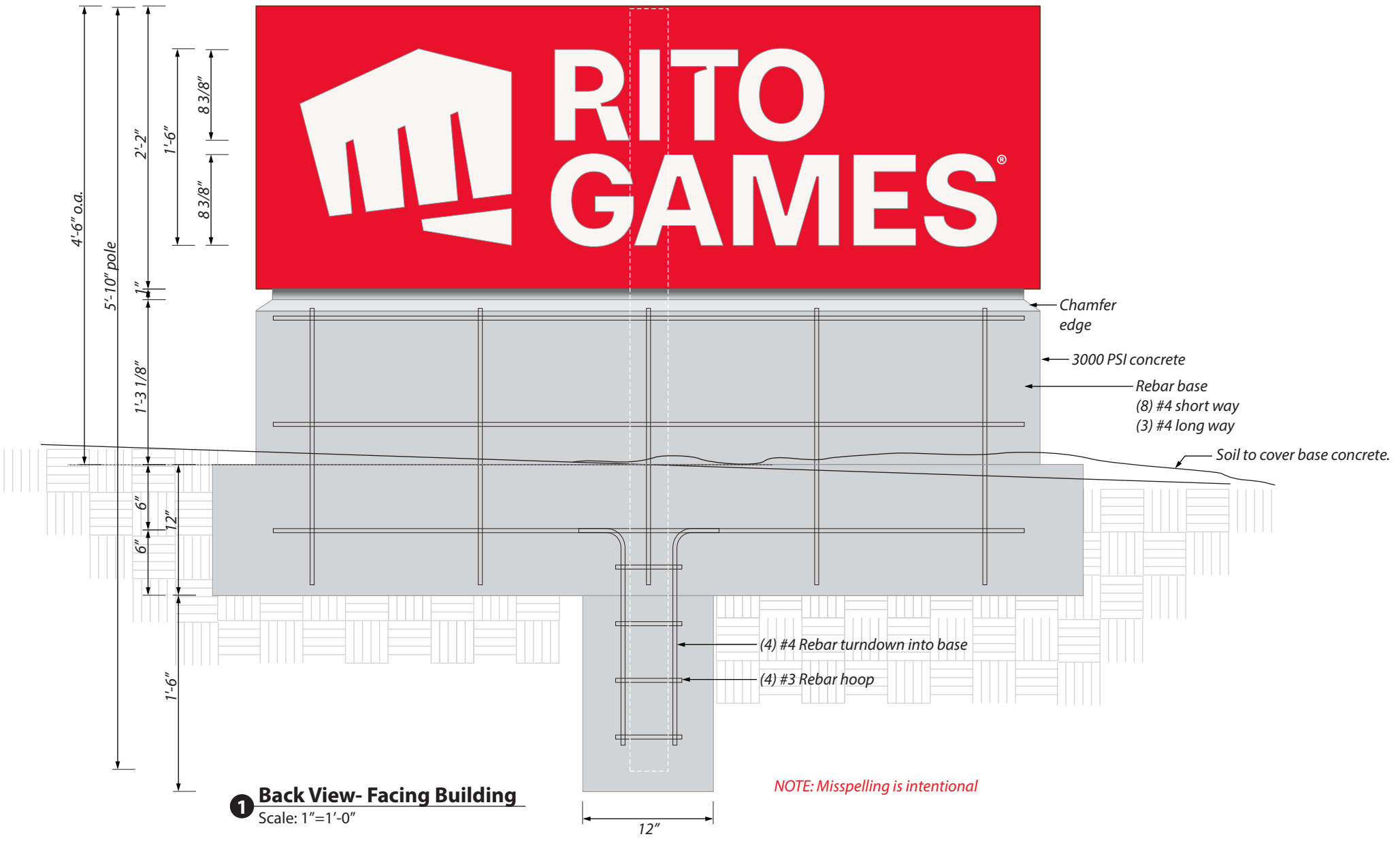
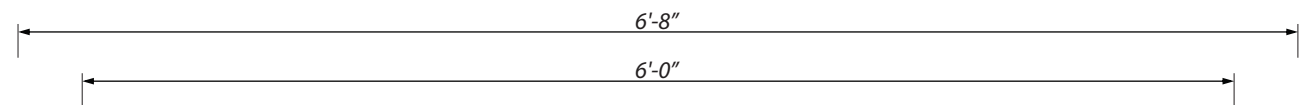

Chamfer edge
3000 PSI concrete
Rebar base
(8) #4 short way
(3) #4 long way
Soil to cover base concrete.

1 Back View- Facing Building
Scale: 1"=1'-0"

NOTE: Misspelling is intentional



Existing Conditions
Scale: NTS



1 Partial East Elevation View
Scale: 1/16"=1'-0"

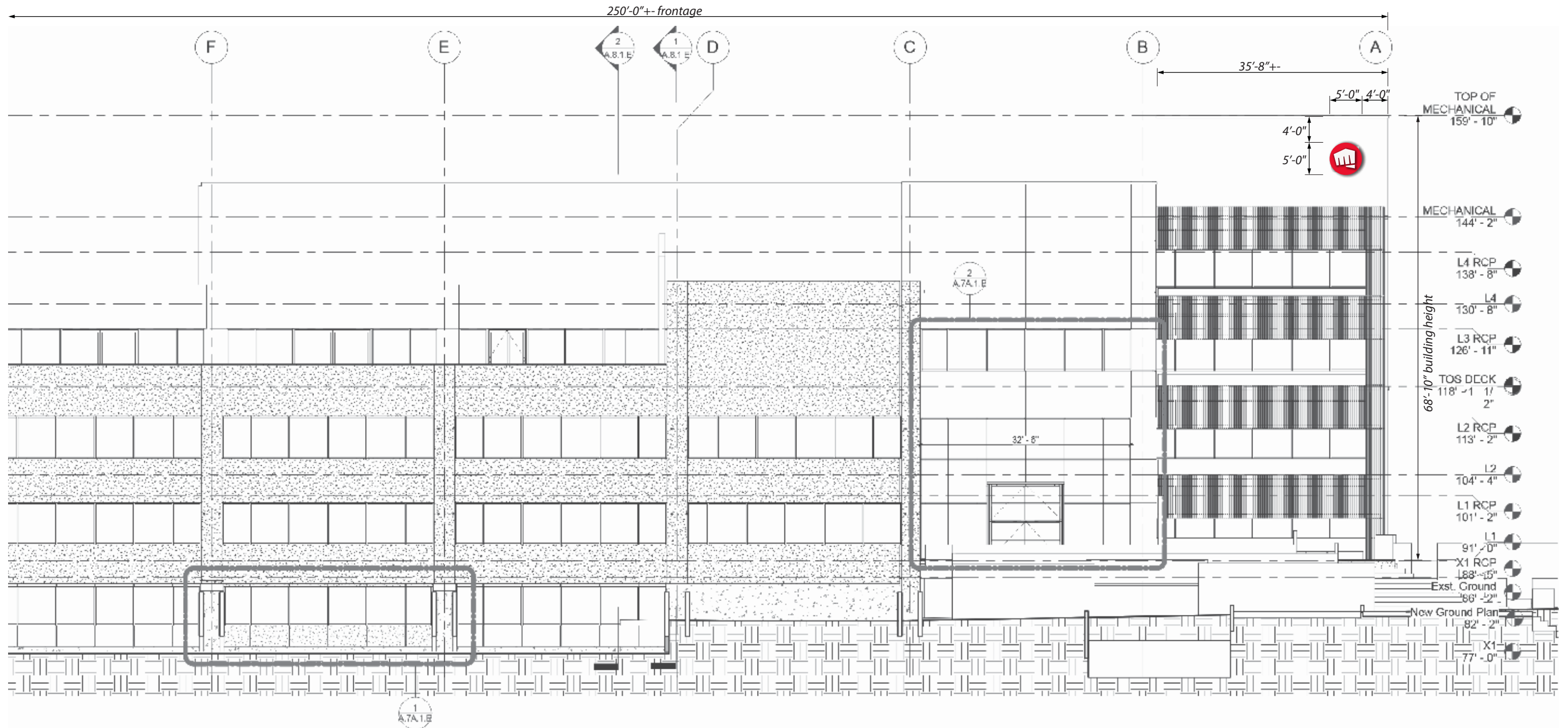

1 Partial East Elevation View
Scale: 1/16"=1'-0"



NATIONAL SIGN
CORPORATION

1541 S. 92nd Place, #B, Seattle, WA 98108
P: 206-282-0700
www.nationalsigncorp.com

This is an original unpublished drawing, created by National Sign Corporation. It is submitted for your personal use in connection with a project being planned for you by National Sign Corporation. It is not to be shown to anyone outside your organization, or to be used, reproduced, copied or exhibited in any fashion. Any usage beyond that granted to buyer herein shall require the separate payment of a design and engineering fee to National Sign Corporation.

JOB INFORMATION:
Riot Games
3003 77TH AVE SE
MERCER ISLAND, WA 98049

REPRESENTATIVE:
Tom Hubbard
DESIGNER:
Mark Mahan

DATE:
06/10/24
DESIGN NUMBER:
24-00386 V9.1 FP

SCALE:
As Noted
24-01764-05.2

FINAL PRINT

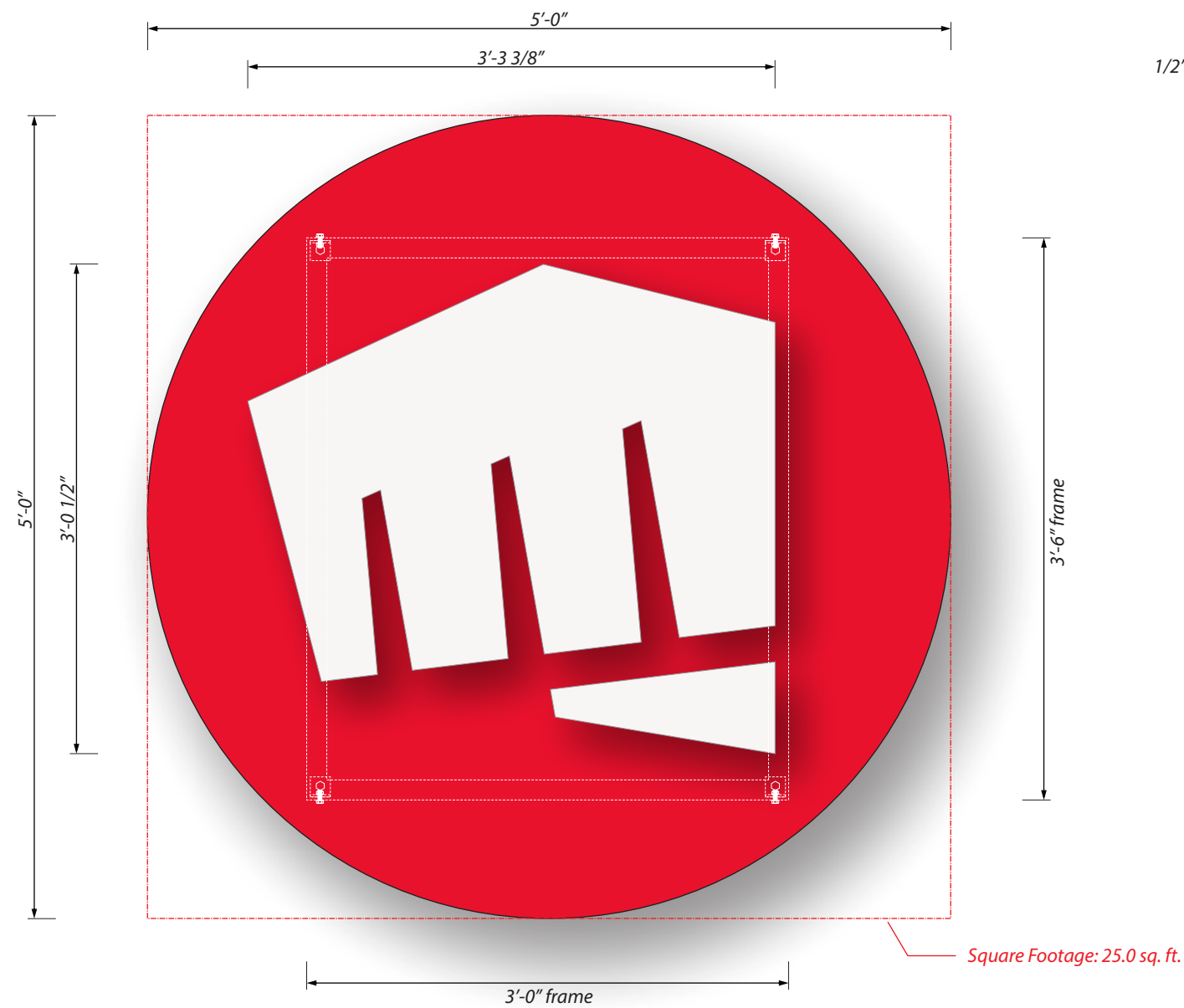

1 Front View- Detail
Scale: 1"=1'-0"

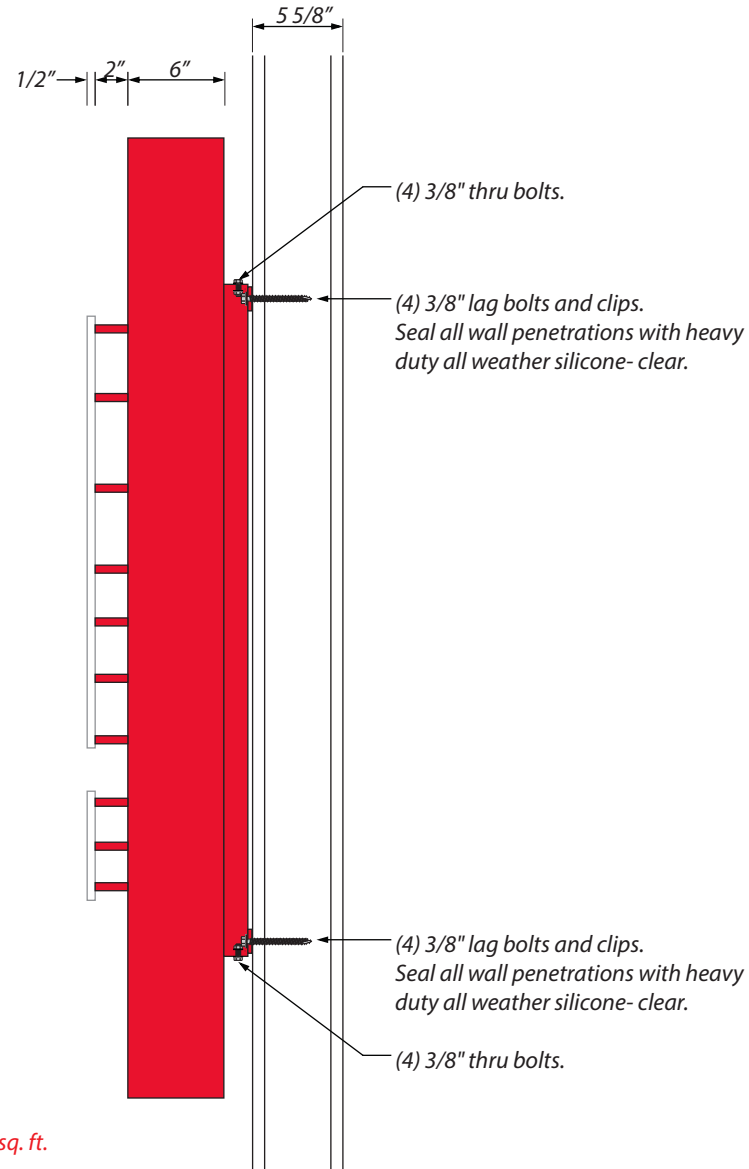

2 Side View
Scale: 1"=1'-0"

Sign 2:

Manufacture and Install (1) Exterior single faced non-illuminated logo cabinet sign.

- A** Oval cabinet to be aluminum construction painted Red to match PMS#185c (satin finish).
- B** Sign face to be .125" aluminum painted Red to match PMS#185c (satin finish).
- C** Sign returns to be .125" aluminum painted Red to match PMS#185c (satin finish).
- D** Graphics to be cut-out of 1/2" thick acrylic painted White (satin finish).
- E** Attach Sign cabinet flush to wall with 1 1/2" x 1 1/2" x 1/4" angle frame painted Red to match PMS#185c (satin finish). (4) 3/8" lag bolts. Seal all wall penetrations with heavy duty all weather silicone- clear.



1541 S. 92nd Place, #B, Seattle, WA 98108
P. 206.282.0700
www.nationalsigncorp.com

CLIENT INFORMATION:

Riot Games
3003 77TH AVE SE
MERCER ISLAND, WA 98049

REPRESENTATIVE:

Tom Hubbard

DESIGNER:

Mark Mahan

DATE:

06/10/24

REVISION:

1	
2	
3	
4	
5	
6	
7	
8	
9	

REVIEWED BY:

F	
C	
S	
P	

This is an original unpublished drawing, created by National Sign Corporation. It is not to be shown to anyone outside your organization, or to be used, reproduced, copied or exhibited in any fashion. Any usage beyond that granted to buyer herein shall require the separate payment of a design and engineering fee to National Sign Corporation.

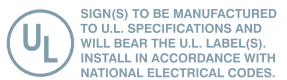

SCALE: As Noted

DESIGN NUMBER:

24-00386 V9.1 FP

JOB NUMBER:

24-01764-OS.2

FINAL PRINT

RIOT GAMES SITE PLAN



1541 S. 92nd Place, #B, Seattle, WA 98108
P. 206.282.0700
www.nationalsigncorp.com

CLIENT INFORMATION:

Riot Games
3003 77TH AVE SE
MERCER ISLAND, WA 98049

REPRESENTATIVE:

Tom Hubbard

DESIGNER:

Mark Mahan

DATE:

06/10/24

REVISION:

1	
2	
3	
4	
5	
6	
7	
8	

REVIEWED BY:

F	
C	
S	
P	

This is an original unpublished drawing, created by National Sign Corporation. It is not to be shown to anyone outside your organization, or to be used, reproduced, copied or exhibited in any fashion. Any usage beyond that granted to buyer herein shall require the separate payment of a design and engineering fee to National Sign Corporation.

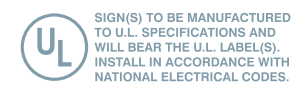

SCALE: As Noted

DESIGN NUMBER:
24-00386 V9.1 FP

JOB NUMBER:
24-01764-OS.1 & 24-01764-OS.2

FINAL PRINT

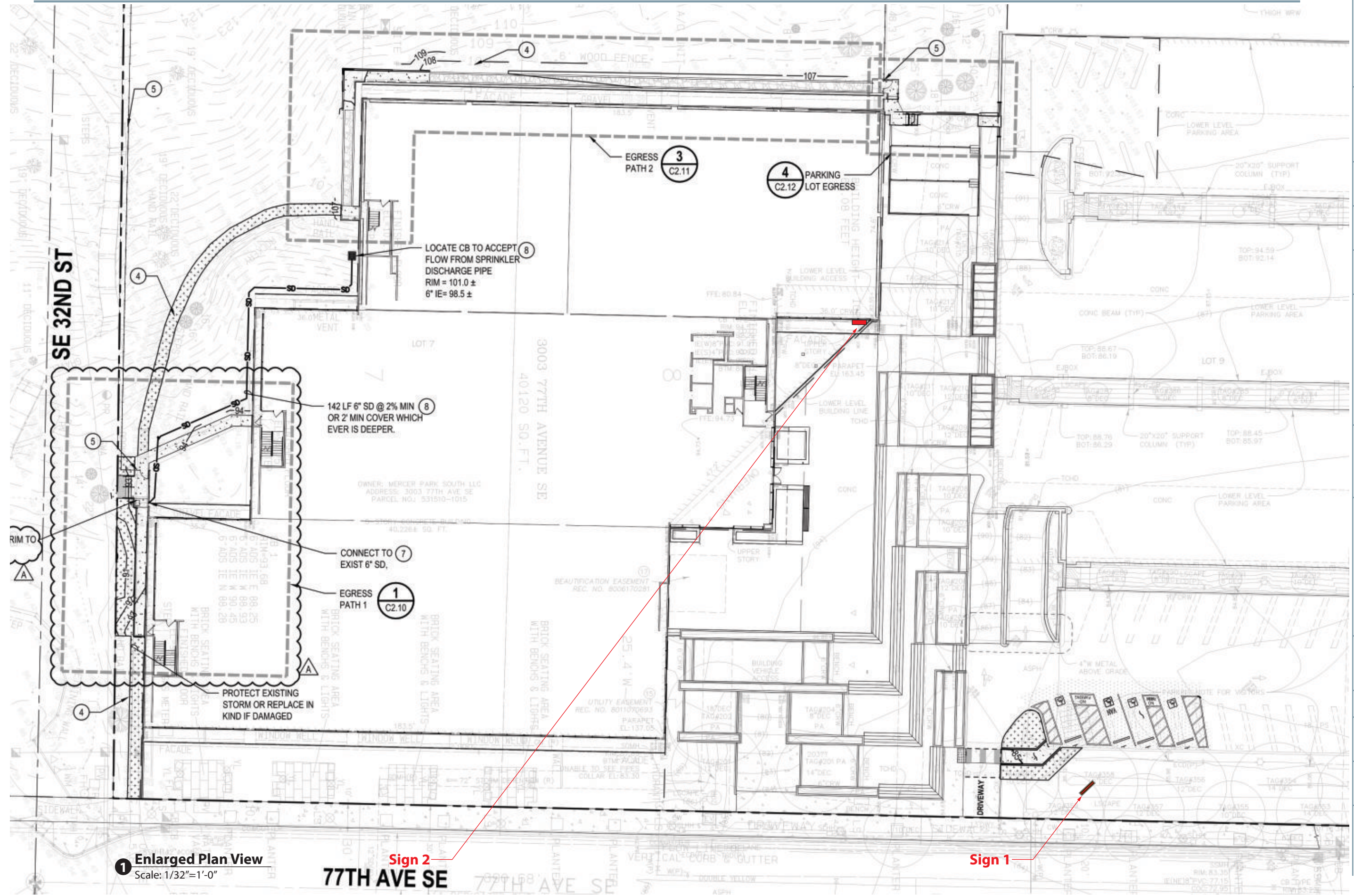

1 Enlarged Plan View
Scale: 1/32"=1'-0"

77TH AVE SE

Sign 1

Sign 2

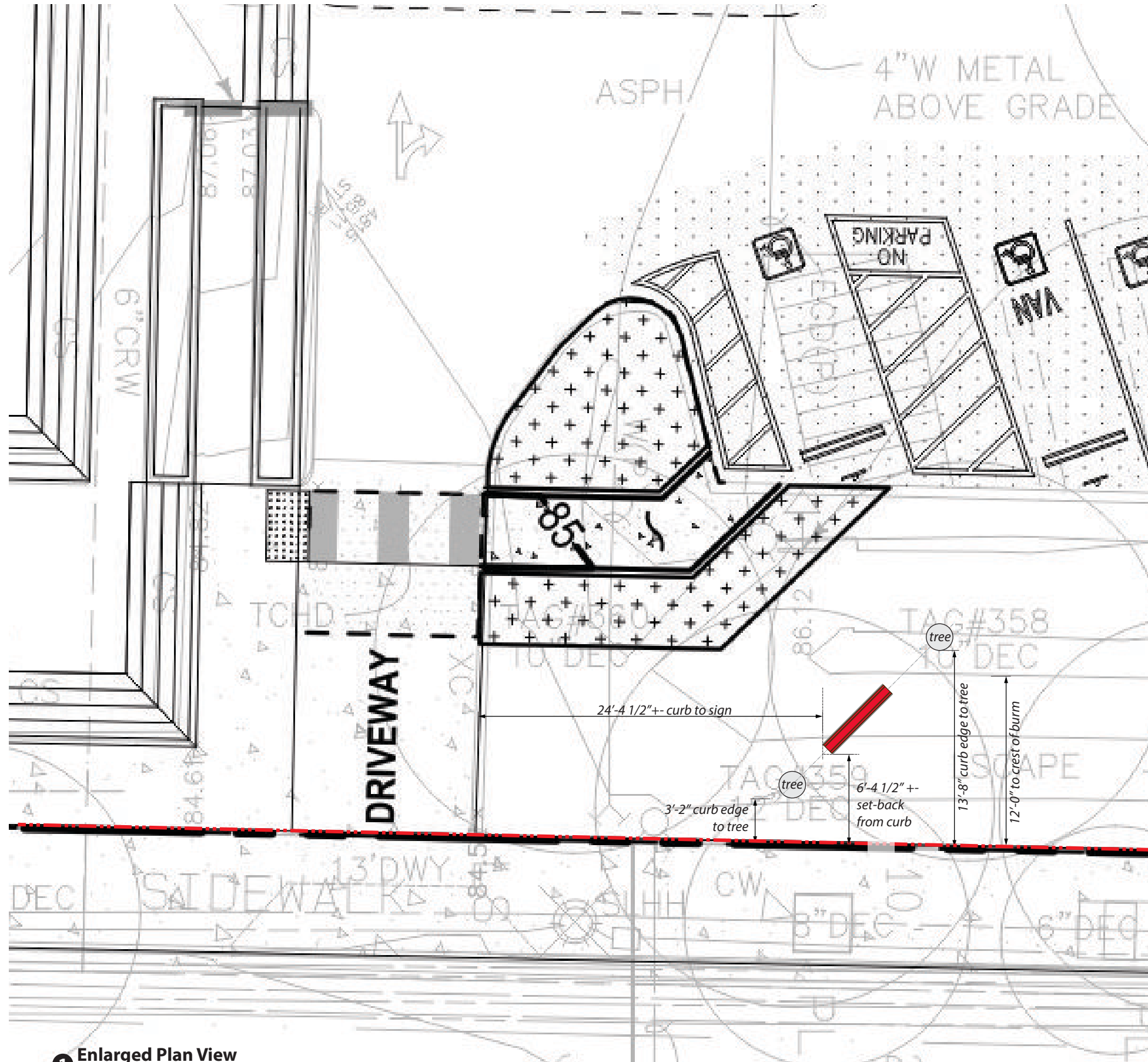

1 Enlarged Plan View
Scale: 1/8"=1'-0"



Existing Conditions
Scale: NTS



Existing Conditions
Scale: NTS



1541 S. 92nd Place, #B, Seattle, WA 98108
P. 206.282.0700
www.nationalsigncorp.com

CLIENT INFORMATION:

Riot Games
3003 77TH AVE SE
MERCER ISLAND, WA 98049

REPRESENTATIVE:

Tom Hubbard

DESIGNER:

Mark Mahan

DATE:

06/10/24

REVISION:

1	
2	
3	
4	
5	
6	
7	
8	
9	

REVIEWED BY:

F	
C	
S	
P	

This is an original unpublished drawing, created by National Sign Corporation. It is not to be shown to anyone outside your organization, or to be used, reproduced, copied or exhibited in any fashion. Any usage beyond that granted to buyer herein shall require the separate payment of a design and engineering fee to National Sign Corporation.

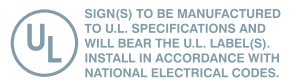

SCALE: As Noted

DESIGN NUMBER:
24-00386 V9.1 FP

JOB NUMBER:
24-01764-OS.2

FINAL PRINT

RIOT GAMES SITE PLAN



1541 S. 92nd Place, #B, Seattle, WA 98108
P. 206.282.0700
www.nationalsigncorp.com

CLIENT INFORMATION:

Riot Games
3003 77TH AVE SE
MERCER ISLAND, WA 98049

REPRESENTATIVE:

Tom Hubbard

DESIGNER:

Mark Mahan

DATE:

06/10/24

REVISION:

1	
2	
3	
4	
5	
6	
7	
8	
9	

REVIEWED BY:

F	
C	
S	
P	

This is an original unpublished drawing, created by National Sign Corporation. It is not to be shown to anyone outside your organization, or to be used, reproduced, copied or exhibited in any fashion. Any usage beyond that granted to buyer herein shall require the separate payment of a design and engineering fee to National Sign Corporation.

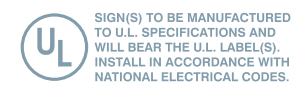

SCALE: As Noted

DESIGN NUMBER:
24-00386 V9.1 FP

JOB NUMBER:
24-01764-OS.1 & 24-01764-OS.2

FINAL PRINT

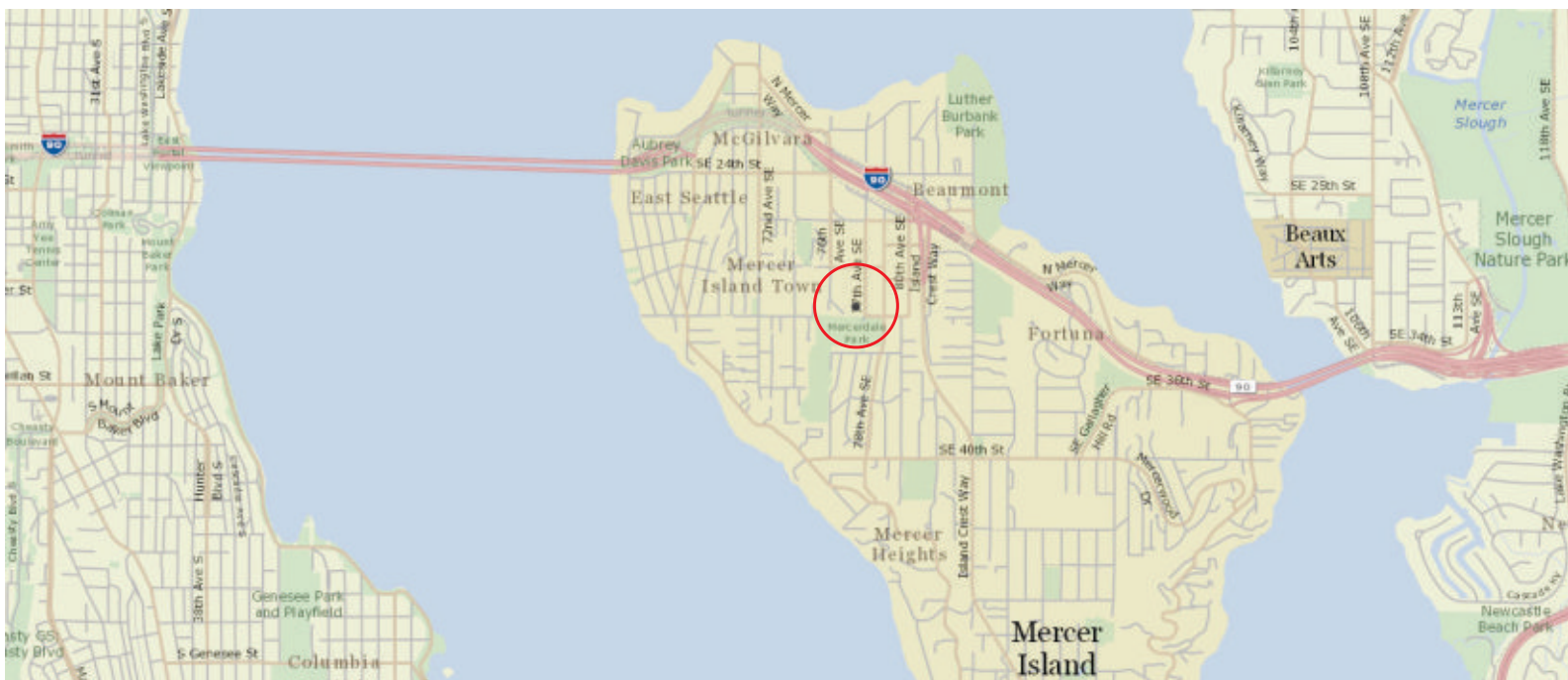

Vicinity Map
Scale: NTS



Aerial View
Scale: NTS

Sign 2 Sign 1



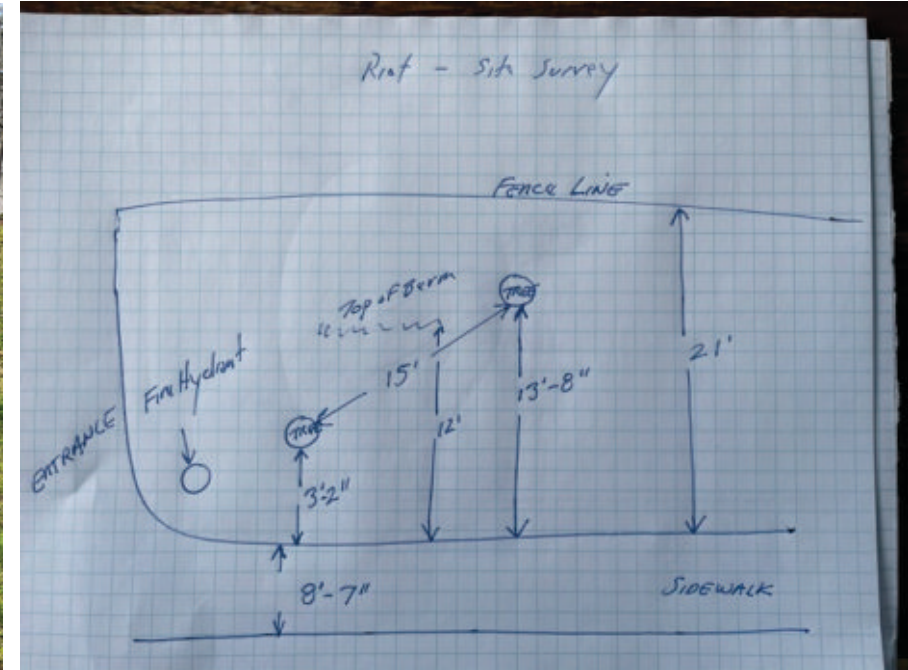

1541 S. 92nd Place, #B, Seattle, WA 98108
P. 206-282-0700
www.nationalsigncorp.com

CLIENT INFORMATION:

Riot Games
3003 77TH AVE SE
MERCER ISLAND, WA 98049

REPRESENTATIVE:

Tom Hubbard

DESIGNER:

Mark Mahan

DATE:

06/10/24

REVISION:

1	
2	
3	
4	
5	
6	
7	
8	
9	

REVIEWED BY:

F	
C	
S	
P	

This is an original unpublished drawing, created by National Sign Corporation. It is not to be shown to anyone outside your organization, or to be used, reproduced, copied or exhibited in any fashion. Any usage beyond that granted to buyer herein shall require the separate payment of a design and engineering fee to National Sign Corporation.

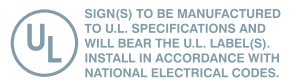

SCALE: As Noted

DESIGN NUMBER:

24-00386 V9.1 FP

JOB NUMBER:

24-01764-OS.1

FINAL PRINT



NATIONAL SIGN
CORPORATION

1541 S. 92nd Place, #B, Seattle, WA 98108
P. 206-282-0700
www.nationalsigncorp.com

CLIENT INFORMATION:

Riot Games
3003 77TH AVE SE
MERCER ISLAND, WA 98049

REPRESENTATIVE:

Tom Hubbard

DESIGNER:

Mark Mahan

DATE:

06/10/24

REVISION:

1	
2	
3	
4	
5	
6	
7	
8	
9	

REVIEWED BY:

F	
C	
S	
P	

This is an original unpublished drawing, created by National Sign Corporation. It is not to be shown to anyone outside your organization, or to be used, reproduced, copied or exhibited in any fashion. Any usage beyond that granted to buyer herein shall require the separate payment of a design and engineering fee to National Sign Corporation.

 SIGN(S) TO BE MANUFACTURED TO U.L. SPECIFICATIONS AND WILL BEAR THE U.L. LABEL(S). INSTALL IN ACCORDANCE WITH NATIONAL ELECTRICAL CODES.

SCALE: As Noted

DESIGN NUMBER:
24-00386 V9.1 FP

JOB NUMBER:
24-01764-OS.2

FINAL PRINT

